

# DB3 Quick user guide

Follow the steps in this guide before you install the tracker



## 1 LOCATE THE IMEI NUMBER



The IMEI number will be printed on the box.  
It can also be found on the device.

If you are an existing user, log in to your GPSlive account and continue to step number 5.

If you have purchased a device with subscription (service top-up) continue to the reverse of this guide.

## 2 REGISTER YOUR ACCOUNT

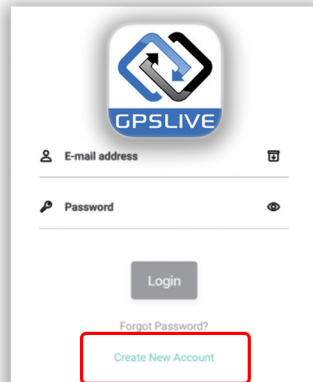

Download the GPSLIVE app from the Apple App Store or Google Play store.  
Open the app and tap on "Create New Account".  
Enter your email address and tap on "Register".

## 3 ACCESS YOUR ACCOUNT

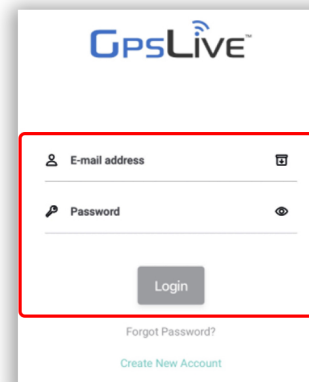

Check your email inbox/spam for an email from GPSLIVE which will contain your username and password.  
Open the GPSLIVE app and log in using the username and password provided in the email.

## 4 SELECT YOUR INTERFACE

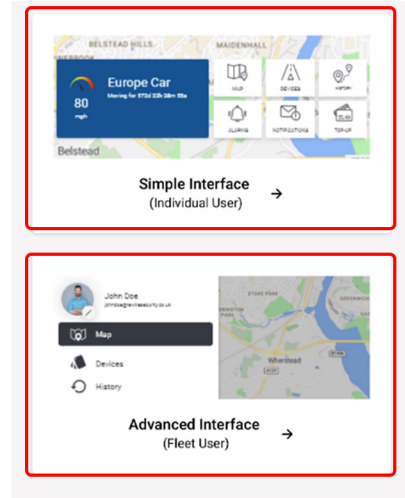

This can be changed in settings at any time.

## 5 ADD YOUR DEVICE

Advanced Interface



Tap on menu button in the top left corner

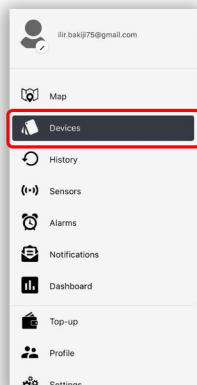

Tap on Devices

Simple Interface

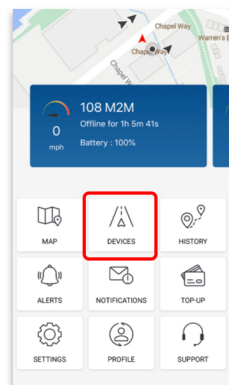

Tap on Devices

Tap on ADD NEW DEVICE



## 6 FILL THE FORM PROVIDED

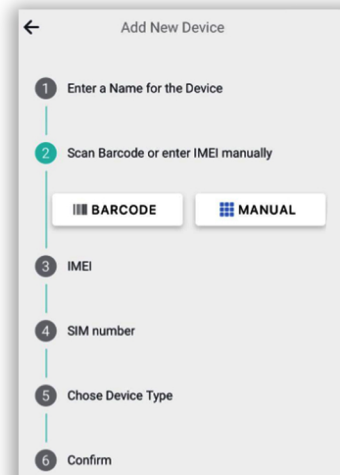

Fill the form provided and tap on Save

## 7 SAVE YOUR DEVICE

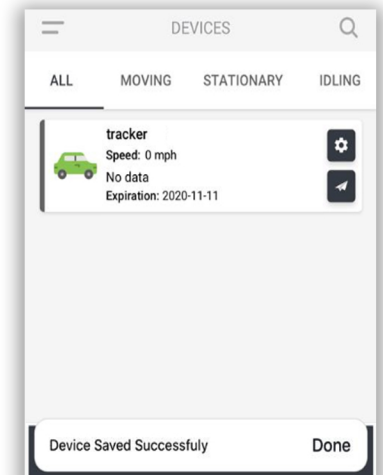

Your Device has been added and activated

# Installation Guide

## WARNING

YOUR DEVICE MUST BE ADDED TO YOUR ACCOUNT BEFORE THE INSTALLATION TAKES PLACE. PLEASE FOLLOW THE INSTRUCTIONS ON THE REVERSE OF THIS USER GUIDE AND THEN INSTALL THE DEVICE.

## Accessing your account

To access your account please visit:  
[WWW.GPSLIVE.CO.UK](http://WWW.GPSLIVE.CO.UK)  
or get our free to download app on  
Google Play or Apple App Store

Please use the details below to log in to your account. You can change your password once you have logged in to your account.

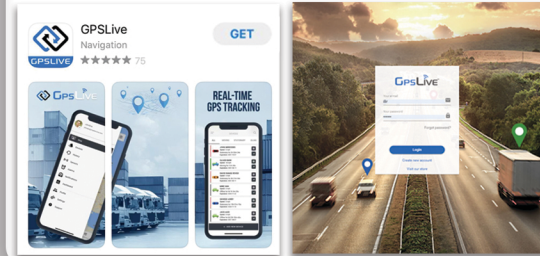

Your login details are going to be displayed here if you have purchased your tracker with service top-up.

## Typical location of the OBD port

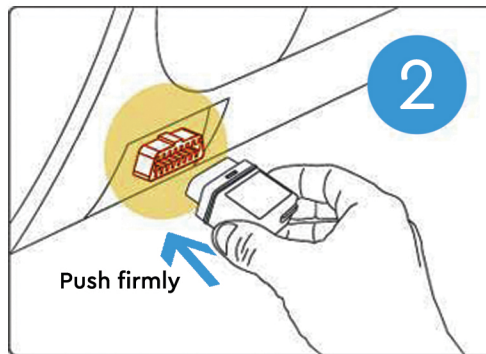
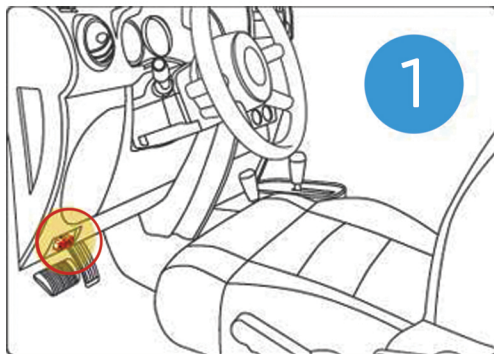
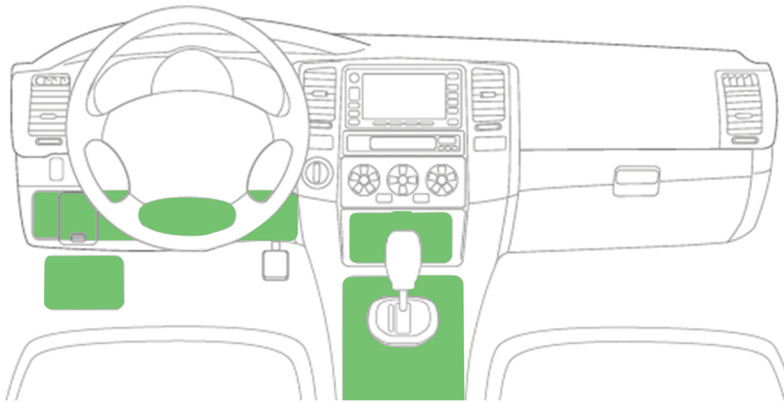

If you just installed the tracker, it may take up to 10 minutes to establish an initial GPS fix.  
If you take your vehicle for a drive, it will allow it to establish a GPS satellite fix faster.

## How do I extend my subscription?

Visit [WWW.GPSLIVE.CO.UK](http://WWW.GPSLIVE.CO.UK) and follow the instructions below:

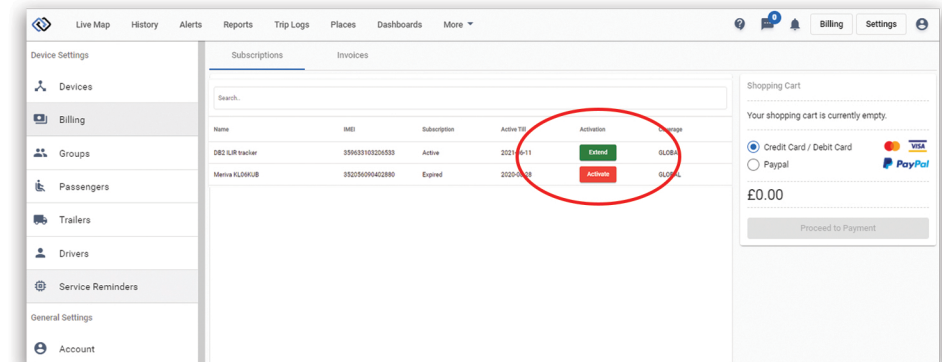

Click on Billing  
In the top right corner

Click on Activate/Extend  
on the device you wish to  
activate or extend

Proceed to the  
payment  
screen

**! IF YOUR SUBSCRIPTION RUNS OUT, YOUR VEHICLE WILL NOT BE PROTECTED AGAINST THEFT AND TRACKING WILL BE DISABLED DURING THIS PERIOD. !**